

**COUNTY OF LOS ANGELES**  
**ROAD DEPARTMENT**

**PRECISE**  
**BENCH MARK LIST**



**NORWALK QUAD**

**1975 ADJUSTMENT**

## P R E F A C E

The Road Department level net is composed of more than 1,500 miles of levels supporting in excess of 18,000 bench marks. In 1975, a major readjustment of the net was undertaken. To emphasize the complete break with previous elevations, the BY,BG & BL series bench marks have been relabeled CY,CG & CL, respectively.

To facilitate the adjustment, indexing, and distribution of adjusted values of the net, the County territory is divided into 34 quads or areas. For identification purposes each quad is given a name, viz., "Rosemead," "La Mirada," "Santa Fe," etc. When bench marks and elevations in the Road Department net are used, the name of the quad in which the bench mark is located and the date of the adjustment of the elevation must be included in the bench mark description, e.g.,

CG 6234 --L+BN IN CONC HDWL OF DRAIN PIPE UNDER DR 218 FT  
NE+18 FT SE C/L INT GRAND AVE + CAMERON AVE MKD (BM)  
(COVINA --1975) ELEV. 696.238

Experience indicates that this general adjustment will, for the most part, remain sound for the next 10 years. Updating constrained adjustments will be made in 5 years. It is expected that these updating adjustments will be in the nature of a few hundredths of a foot. When a quad is readjusted, new elevation lists will be published and the date of the readjustment will replace the "1975" at the end of the bench mark description. Two bench marks with different adjustment dates will not normally agree with each other.

The basic accuracy of the net is reflected by an indicated field probable error of plus or minus 0.012 foot per mile of leveling as determined from over 600 conditions of closure. However, many years experience in vertical control in the greater Los Angeles basin and Antelope Valley indicate that because of varying degrees of subsidence and heaving, the true datum is recovered only by obtaining substantial agreement of a number of bench marks.

The users of this net are invited to assist in its maintenance by notifying this Department of cases of obliteration, apparent mistakes in descriptions or elevations, and proven disturbance of bench marks.

---

DATUM: U. S. Coast and Geodetic Survey Sea Level Datum  
of 1929, through the medium of the Los Angeles  
County Engineer Precise Level Net.

ABBREVIATIONS USED IN BENCH MARK LISTINGS

ABUT - - - - -	Abutment	EC - - - - -	End of Curve
ALG - - - - -	Along	ENT - - - - -	Entrance
ANG PT - - - - -	Angle Point	FL - - - - -	Floor
B/W - - - - -	Back of Walk	FTG - - - - -	Footing
BCR - - - - -	Beginning of Curb Return	F/W - - - - -	Front of Walk
BC - - - - -	Beginning of Curve	GAR - - - - -	Garage
BLDG - - - - -	Building	HDWL - - - - -	Headwall
BM - - - - -	Bench Mark	HSE - - - - -	House
BT SPK - - - - -	Boat or Bolt Spike	INT - - - - -	Intersection
BR CAP - - - - -	Brass or Bronze Cap	IP - - - - -	Iron Pipe
C B - - - - -	Catch Basin	LT - - - - -	Left
CTR - - - - -	Center	LACE - - - - -	L. A. City Engineer
C/L - - - - -	Center Line	LACS - - - - -	L. A. County Engineer
C/L INT - - - - -	Center Line Intersection	L AFC - - - - -	L. A. Co. Flood Control
C/L PROD - - - - -	Center Line Produced	L+BN - - - - -	Lead and Bench Nail
CONC - - - - -	Concrete	L+BR - - - - -	Lead and Brad
COR - - - - -	Corner	L+N - - - - -	Lead and Nail
COE - - - - -	Corps of Engineers	L+RDEM TAG - - - - -	Lead and Road Dept. Bench Mark Tag
CULV - - - - -	Culvert	L+SPK - - - - -	Lead and Spike
CB - - - - -	Curb	L+T - - - - -	Lead and Tack
CS MON - - - - -	County Engineer Monument	MCR - - - - -	Middle of Curb Return
CS BR CAP - - - - -	County Engineer Brass Cap	MKD - - - - -	Marked
CT SPK - - - - -	Cut Spike	MC - - - - -	Middle of Curve
DR - - - - -	Drive or Driveway	MON - - - - -	Monument
E/O - - - - -	East of	N/O - - - - -	North of
ECR - - - - -	End of Curb Return	NR - - - - -	Near

ABBREVIATIONS USED IN BENCH MARK LISTINGS . . . CONTINUED

OPP - - - - - Opposite  
PI - - - - - Point of Intersection  
PK+W - - - - - PK Nail and Washer  
P/L - - - - - Property Line  
POST - - - - - Point on Semi-Tangent  
PP - - - - - Power Pole  
PVMT - - - - - Pavement  
PROD - - - - - Produced  
RD - - - - - Road  
RDBM - - - - - Road Dept. Bench Mark  
RR - - - - - Railroad  
RT - - - - - Right  
R/W - - - - - Right of Way  
SDMH - - - - - Storm Drain Manhole  
SMH - - - - - Sewer Manhole  
SPK - - - - - Spike  
ST+W - - - - - Spike Tin and Washer  
S/O - - - - - South of  
TP - - - - - Telephone Pole  
USC+GS - - - - - U. S. Coast and Geodetic Survey  
USGS - - - - - U. S. Geological Survey  
WK - - - - - Walk  
W/O - - - - - West of

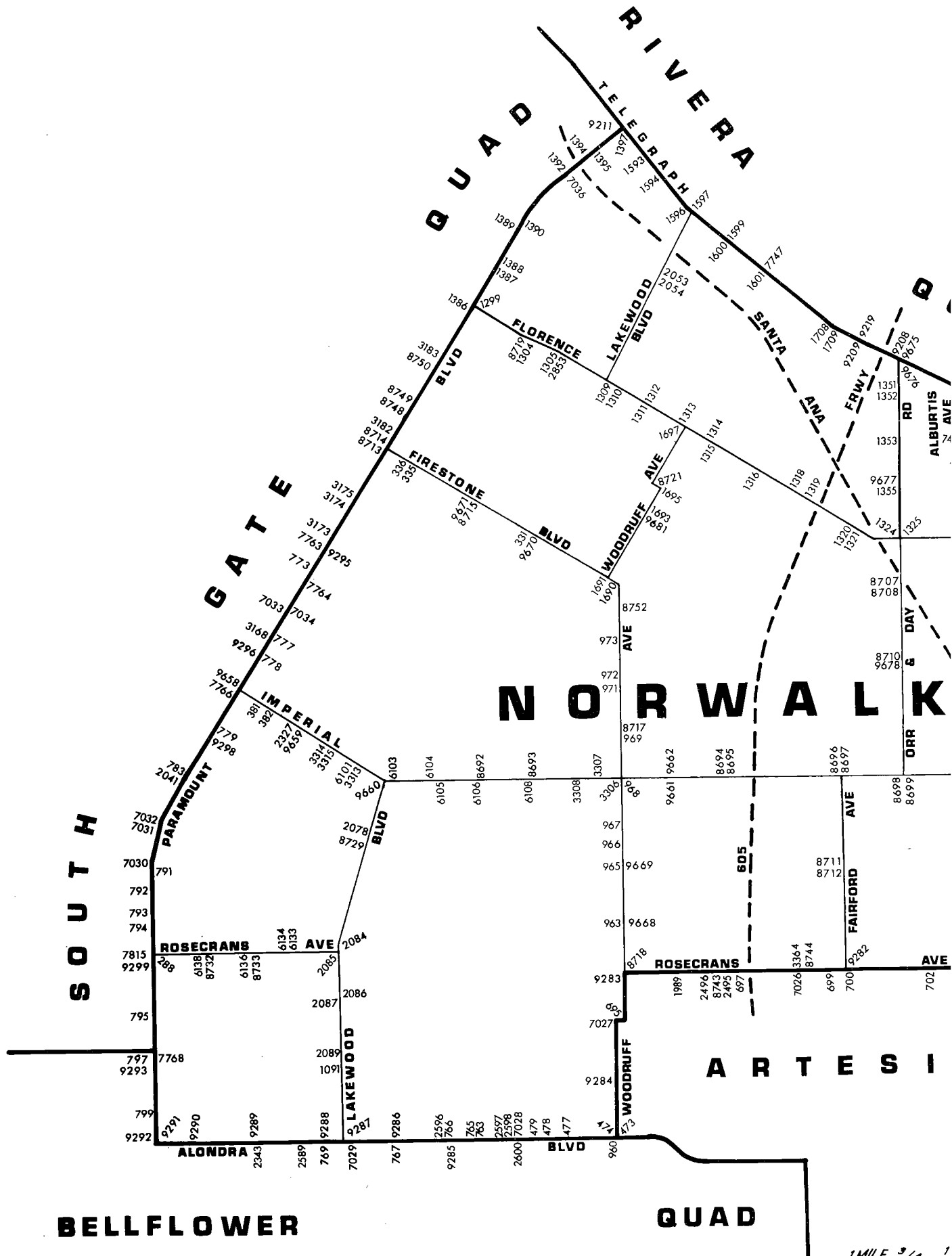

1 MILE 3/4 1/2



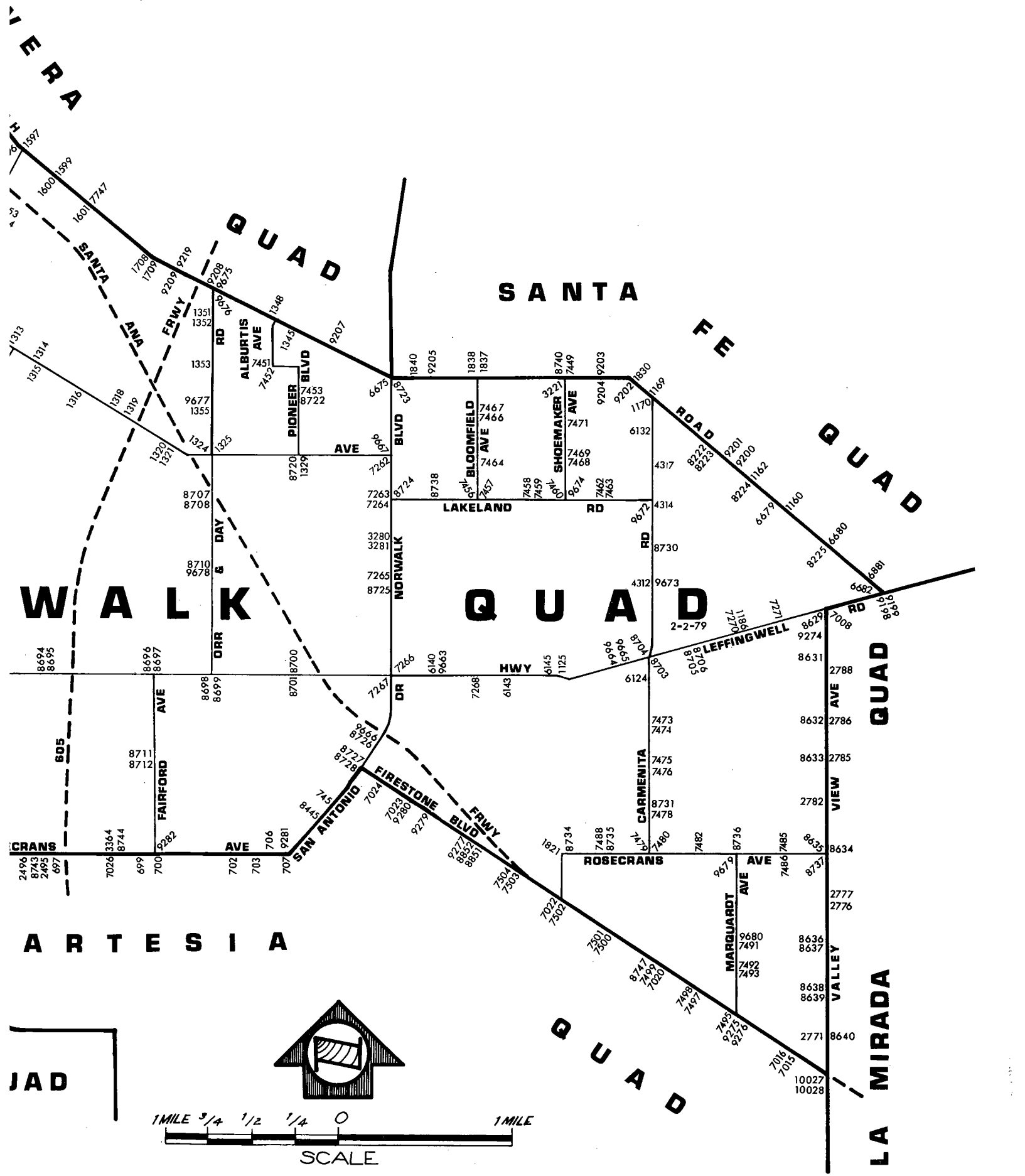

YERA

QUAD

SANTA

FE

QUAD

WALK

QUAD

QUAD

ARTESIA

QUAD

LA MIRADA

JAD

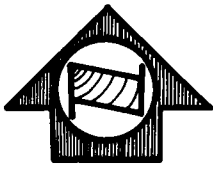

QUAD-YEAR	ELEV	DESCRIPTION (INCLUDE QUAD AND YEAR IN DESCRIPTION)	BM NUMBER
BASELINE (1975)	73.432	4.5 IN IP WITH L&T 6IN BACK WK ON SE COR PARAMOUNT BLVD & ROSECRANS AVE 244FT S C/L 50FT E C/L INT MKD (LAC 32)	CY 288
NORWALK (1975)	111.563	L&T S CB FIRESTONE BLVD 1FT E CB RET @ NASH AVE 38FT S & 29FT E/O C/L INT	CY 331
NORWALK (1975)	113.245	L&T S CB FIRESTONE BLVD 1FT E CB RET @ SE COR LA RENA AVE 38FT S & 31FT E C/L INT	CY 335
NORWALK (1975)	112.486	L&T CB FIRESTONE BLVD 1 FT E CB RET @ SE COR MYRTLE ST 38FT S & 32FT E C/L INT	CY 336
NORWALK (1975)	96.158	L & BN 1FT E BCR @ SE COR IMPERIAL HWY & BROCK AVE 75FT S & 45FT E/O C/L INT MKD (BM ZA5)	CY 381
NORWALK (1975)	96.505	L & T SE COR IMPERIAL HWY & ORIZABA AVE 40FT E & 75FT S/O C/L INT MKD (BM)	CY 382
BASELINE (1975)	92.748	L&T 5FT E CB RET @ NE COR SYCAMORE ST & SAN ANTONIO DR 74FT E & 18FT N C/L INT	CY 445
BASELINE (1975)	73.117	CS REF MON IN WELL 14IN DN ON NE COR ALONDRA BLVD & WOODRUFF AVE 56FT N & 60FT E/O C/L INT MKD (CLEARWATER K 2A)	CY 473
BASELINE (1975)	73.744	CSBM MON FL ON NW COR ALONDRA BLVD & WOODRUFF AVE 39FT N & 180FT W C/L INT MKD (BM 6-6A1958)	CY 474
BASELINE (1975)	74.723	L&N 18FT E C/L ENCALYPTUS AVE & 80FT S C/L ALONDRA BL	CY 477
BASELINE (1975)	75.185	L & T 15FT E C/L LEAHY AVE & 80FT N C/L ALONDRA BL	CY 478
BASELINE (1975)	75.165	L & T 15FT W C/L LEAHY AVE & 80FT N C/L ALONDRA BL	CY 479
BASELINE (1975)	80.782	RD HD SPK&L W CB 28FT N BCR @ NW COR WOODRUFF AVE & WASHINGTON ST 70FT N & 40FT W C/L INT MKD ( MV 26)	CY 695
BASELINE (1975)	87.493	FC BRONZE DISC @ SW COR DAIRY PLATFORM 75FT N C/L ROSECRANS AVE 300FT E SAN GABRIEL RIVER BRIDGE ( BM 75-9C )	CY 697
BASELINE (1975)	84.396	L&N 1FT E BCR @ SE COR ROSECRANS AVE & CROSSDALE AVE 40FT S & 50FT E C/L INT	CY 699
BASELINE (1975)	84.684	L&N 1FT E BCR @ SE COR ROSECRANS AVE & ELMCROFT AVE 40FT S & 50FT E C/L INT	CY 700

QUAD-YEAR	ELEV	DESCRIPTION (INCLUDE QUAD AND YEAR IN DESCRIPTION)	BM NUMBER
BASELINE (1975)	85.053	L&N 1FT E BCR @ SE COR ROSECRANS AVE & GARD AVE 38FT S & 50FT E C/L INT	CY 702
BASELINE (1975)	86.646	L&N 1FT S BCR @ SE COR ROSECRANS AVE & JERSEY AVE 68FT S & 18FT E C/L INT	CY 703
BASELINE (1975)	86.391	CS MON IN WELL 13IN DN ON NW COR ROSECRANS AVE & PIONEER BLVD 86FT N & 40FT W C/L INT MKD (WHITTIER C 124 1959)	CY 706
BASELINE (1975)	86.923	RDBM MON FLUSH IN CONC SQ POST ON SW COR ROSECRANS AVE & ARLEE AVE 83FT S & 20FT W C/L INT MKD (BM 184)	CY 707
BASELINE (1975)	71.783	L&T 2FT W CB RET NW COR RYON AVE & ALONDRA BLVD 38FT N & 32FT W C/L INT	CY 763
BASELINE (1975)	73.661	L&BN S CB ALONDRA BLVD 6IN E CB RET @ SE COR ALONDRA BLVD & PACIFIC AVE 70FT W PERR	CY 765
BASELINE (1975)	68.586	L & SPK 4FT E CB RET @ NE COR CLARK AVE & ALONDRA BLVD 38FT N & 59FT E C/L INT	CY 766
BASELINE (1975)	69.592	L&T C/L INT VIRGINIA DR & ALONDRA BLVD	CY 767
BASELINE (1975)	68.374	L&T C/L INT PITTS AVE & ALONDRA BLVD	CY 769
BASELINE (1975)	108.417	L&SPK IN WK 55FT N/O C/L COLE ST & 50FT W/O C/L PARAMOUNT BLVD MKD ( 0-31 )	CY 773
BASELINE (1975)	104.856	L&T 14FT E C/L PARAMOUNT BLVD 11FT N C/L SPRINGER ST PROD IN CONC PVMT	CY 777
BASELINE (1975)	103.961	L&T IN CONC 14FT E C/L PARAMOUNT BLVD 4FT N C/L QUILL DR PROD	CY 778
BASELINE (1975)	90.416	L & T 1FT N BCR @ NE COR PARAMOUNT BLVD & ADOREE AVE 58FT N & 38FT E C/L INT	CY 779
BASELINE (1975)	82.561	CS MON 16FT W & 5FT S INT PARAMOUNT BLVD & GARDENDALE ST	CY 783
BASELINE (1975)	77.754	L & T 10FT S BCR INTO CB RET @ NE COR PARAMOUNT BLVD & CENTURY BLVD 2FT N & 41FT E C/L INT	CY 791
BASELINE (1975)	76.271	BT SPK 1FT S BCR @ SW COR PARAMOUNT BLVD & PEARLE ST 32FT S & 38FT W C/L INT MKD (H-110)	CY 792
BASELINE (1975)	75.489	BT SPK BCR @ SW COR PARAMOUNT BLVD & HOWE ST 30FT S & 38FT W C/L INT	CY 793



QUAD-YEAR	ELEV	DESCRIPTION (INCLUDE QUAD AND YEAR IN DESCRIPTION)	BM NUMBER
BASELINE (1975)	76.316	BT SPK CTR CB RET @ NW COR PARAMOUNT BLVD & ROSE ST 18FT N & 40FT W C/L INT MKD (H 112)	CY 794
BASELINE (1975)	71.548	L & T IN CB 38FT W C/L PARAMOUNT BLVD ON THIRD ST C/L PROD	CY 795
BASELINE (1975)	72.315	CS MON 17FT W/O C/L PARAMOUNT BLVD ON C/L COMPTON BLVD MKD ( RE 2177 CLEARWATER )	CY 797
BASELINE (1975)	68.556	L&T W CB PARAMOUNT BLVD 2FT N CB RET @ NW COR MADISON ST & PARAMOUNT BLVD	CY 799
BASELINE (1975)	73.494	L&T IN S CB ALONDRA BLVD 1FT E INTO RET 68FT W C/L WOODRUFF AVE & 38FT S/O C/L ALONDRA BLVD	CY 960
NORWALK (1975)	87.907	RDBM TAG W CB WOODRUFF AVE 40FT W/O C/L 20FT S/O C/L PROD ARTHURDALE ST	CY 963
NORWALK (1975)	90.438	L&T N CB 1.5FT W BCR @ NW COR WOODRUFF AVE & FOSTER RD 36FT N/O & 100FT W/O C/L INT MKD (BM)	CY 965
NORWALK (1975)	91.003	L&T 1FT W ECR @ SW COR WOODRUFF AVE & BELCHER ST 18FT S & 91FT W C/L INT MKD ( BM )	CY 966
NORWALK (1975)	91.778	L&T 1FT S BCR @ SW COR RATLIFFE ST & WOODRUFF AVE SERVICE RD 47FT S & 72FT W C/L INT MKD (BM)	CY 967
NORWALK (1975)	95.392	RDBM TAG S CB 5FT W/O BCR @ SE COR IMPERIAL HWY & WOODRUFF AV 41FT S/O & 65FT E/O C/L INT	CY 968
NORWALK (1975)	98.369	LS TAG NO 2428 E CB WOODRUFF AVE ON OR NEAR C/L PROD EVEREST ST 55FT E/O C/L IN ENTRANCE TO SCHOOL BUS DRIVE	CY 969
NORWALK (1975)	100.650	RDBM TAG W CB 45FT S/O BCR @ SW COR WOODRUFF AVE & WASHBURN RD 90FT S/O & 40FT W/O C/L INT	CY 971
NORWALK (1975)	100.404	CS MON IN WELL 10 INCHES DN @ OR NEAR C/L INT WOODRUFF AVE & WASHBURN RD MKD (CO SUR MON RE329)	CY 972
NORWALK (1975)	103.777	RDBM TAG W CB 1FT S/O BCR @ SW COR WOODRUFF AVE & STEWART&GRAY RD 70FT S/O & 40FT W/O C/L INT	CY 973
NORWALK (1975)	77.264	RAILROAD SPK @ INT PERR (SANTA ANA LINE) & LAKEWOOD BLVD 0.1MI S/O C/L COMPTON BLVD	CY 1091
NORWALK (1975)	122.378	L&T WLY CB 1FT NLY BCR @ NWLY COR IMPERIAL HWY & SHOEMAKER AVE 80FT NLY & 32FT WLY APPROX C/L INT	CY 1125

QUAD-YEAR	ELEV	DESCRIPTION (INCLUDE QUAD AND YEAR IN DESCRIPTION)	BM NUMBER
BASELINE (1975)	175.276	L&SPK N BCR @ NE COR TELEGRAPH RD & CERES ST 61FT N & 20FT E C/L INT MKD (WZ 399)	CY 1160
BASELINE (1975)	134.408	L&T N CB 1FT W BCR @ NW COR TELEGRAPH RD & VICTORIA AVE 42FT N & 48FT W C/L INT	CY 1162
BASELINE (1975)	157.074	L&T N CB 3FT E OF BCR @ NE COR TELEGRAPH RD & CARMENITA RD 38FT N & 50FT E C/L INT	CY 1169
BASELINE (1975)	156.199	CS MON IN WELL 14IN DN 15FT S & 25FT E C/L INT TELEGRAPH RD & CARMENITA RD MKD (WHITTIER G8)	CY 1170
NORWALK (1975)	109.137	L&T ELY CB 7FT NLY BCR @ NELY COR LEFFINGWELL RD & MEYER RD 48FT NLY * 40FT ELY APPROX C/L INT	CY 1186
BASELINE (1975)	125.802	RDBM TAG N CB 1FT E BCR @ NE COR PARAMOUNT BLVD & FLORENCE AVE 40FT N & 68FT E C/L INT	CY 1299
NORWALK (1975)	126.744	L & BN 40FT E MAC DRWY TO HSE NO 8358 FLORENCE AVE 38FT S C/L & 700FT E DOWNEY AVE	CY 1304
NORWALK (1975)	129.437	L&T 5FT W/O BCR @ SW COR FLORENCE AVE & BROCKSHIRE AVE 40FT S & 62FT W/O C/L INT MKD (BM)	CY 1305
NORWALK (1975)	125.989	L&BN W CB 16FT S BCR @ SW COR FLORENCE AVE & LAKEWOOD BLVD 80FT S & 40FT W C/L INT MKD (BM)	CY 1309
NORWALK (1975)	125.336	L&BN E CB (DEPRESSED) 15FT S OF BCR @ SE COR FLORENCE AVE & LAKEWOOD BLVD 90FT S & 40FT E C/L INT MKD (BM)	CY 1310
NORWALK (1975)	125.155	L&T S CB 38FT S C/L OF FLORENCE AVE 48FT W C/L HALLEDON AVE (PRGD) MKD (BM)	CY 1311
NORWALK (1975)	125.434	L&T W CB 4FT N/O BCR @ NW COR HALLEDON AVE & FLORENCE AVE 78FT N & 20FT W C/L INT MKD (BM)	CY 1312
NORWALK (1975)	128.380	L&PK 38FT N C/L FLORENCE AVE 21FT W C/L PRGD OF WOODRUFF AVE	CY 1313
NORWALK (1975)	124.806	RDBM TAG N CB 1FT W OF BCR @ NW COR DOWNEY- SANFORD BRIDGE RD & FLORENCE AVE 38FT N & 55FT W C/L INT	CY 1314
NORWALK (1975)	124.358	L&T 38FT S C/L FLORENCE AVE ON OR NEAR C/L PRGD OF DOWNEY-SANFORD BRIDGE RD MKD (BM)	CY 1315
NORWALK (1975)	120.787	L&T IN S CB 4FT W OF BCR OF SW COR LESTERFORD AVE & FLORENCE AVE 38FT S & 58FT W C/L INT MKD (BM)	CY 1316

QUAD-YEAR	ELEV	DESCRIPTION (INCLUDE QUAD AND YEAR IN DESCRIPTION)	BM NUMBER
NORWALK (1975)	133.416	C OF ENG BR CAP N CB @ W END OF BRIDGE NO B933 ON FLORENCE AVE OVER SAN GABRIEL RIVER 25FT N/O C/L FLORENCE AVE MKD (1959)	CY 1318
NORWALK (1975)	131.008	C OF ENG BR CAP N CB @ E END BRIDGE NO B933 ON FLORENCE AVE OVER SAN GABRIEL RIVER 25FT N/O C/L FLORENCE AVE MKD (1959)	CY 1319
NORWALK (1975)	117.820	RDBM TAG S OF CB 1FT E/O BCR @ SW COR FLORENCE AVE & FAIRFORD AVE 38FT S & 18FT W/O C/L	CY 1320
NORWALK (1975)	119.215	LA CO RDBM TAG E CB 1FT S/O BCR @ SE COR FLORENCE AVE & FAIRFORD AVE 125FT S & 20FT E/O C/L INT	CY 1321
NORWALK (1975)	121.333	L&T N CB 1FT W/O BCR @ NW COR FLORENCE AVE & ORR & DAY RD 38FT N & 75 FT W/O C/L INT MKD (BM)	CY 1324
NORWALK (1975)	120.501	RDBM TAG N CB 1FT W/O BCR @ NE COR FLORENCE AVE & ORR & DAY RD 38FT N & 75FT E/O C/L INT	CY 1325
NORWALK (1975)	118.115	RDBM TAG S CB 5FT W/O BCR @ SE COR FLORENCE AVE & PIONEER BLVD 38FT S/O & 70FT E/O C/L INT	CY 1329
BASELINE (1975)	131.157	RDBM TAG IN S CB TELEGRAPH RD 2FT W/O SW CB RET @ MAIN DRWY TO SANTA FE SPRINGS FIRE STA BLDG NO 11736 40FT S/O C/L TELEGRAPH RD & 390FT W/O C/L PIONEER BLVD	CY 1345
BASELINE (1975)	131.516	CS MON IN WELL @ C/L INT TELEGRAPH RD & ALBURTIS AVE NLY MKD (LACS CON SYS TRA STA WHITTIER B-7 RE2177 1941)	CY 1348
NORWALK (1975)	130.014	L&T E CB W SERVICE RD 4FT S BCR 50FT W & 40FT S C/L INT ORR & DAY RD & DAVENRICH ST MKD (BM)	CY 1351
NORWALK (1975)	129.646	L&T W CB W SERVICE RD 15FT S BCR 78FT W & 60 FT S C/L INT ORR & DAY RD & DAVENRICH ST MKD (BM)	CY 1352
NORWALK (1975)	128.038	L&T IN E CB W SERVICE RD 12FT N BCR 50FT W & 46FT N C/L INT ORR & DAY RD & DUNNING ST MKD (BM)	CY 1353
NORWALK (1975)	123.264	RDBM TAG IN W CB ORR & DAY RD 1FT S BCR 40FT W 35FT S C/L INT CLARKMAN ST	CY 1355
BASELINE (1975)	124.480	CS BR CAP CONC MON IN WELL @ C/L INT PARAMOUNT BLVD & FLORENCE AVE	CY 1386

QUAD-YEAR	ELEV	DESCRIPTION (INCLUDE QUAD AND YEAR IN DESCRIPTION)	BM NUMBER
BASELINE (1975)	127.200	L & BRAD CTR CB RET SE COR LUBEC ST & PARAMOUNT BLVD 25FT S & 52FT E C/L INT	CY 1387
BASELINE (1975)	127.420	L & BRAD CTR CB RET NE COR LUBEC ST & PARAMOUNT BLVD 27FT N & 52FT E C/L INT	CY 1388
BASELINE (1975)	130.387	L&BN W CB PARAMOUNT BLVD @ NLY P L HSE NO 9603 33FT W/O C/L PARAMOUNT BLVD	CY 1389
BASELINE (1975)	131.832	L & T CONC CB @ BCR SE COR SUVA ST & PARAMOUNT BLVD 48FT S & 38FT E C/L INT MKD (8M)	CY 1390
BASELINE (1975)	134.278	L & T IN CONC CB @ BCR @ SW COR GALLATIN RD & PARAMOUNT BLVD 53FT S & 38FT W C/L INT	CY 1392
BASELINE (1975)	138.485	SQ HD SPK W CB OF SERVICE RD OF PARAMOUNT BLVD 12FT N C/L PROD BROOKGREEN RD	CY 1394
BASELINE (1975)	139.448	FD L&BRAD E CB 0.5FT S BCR @ SE COR PARAMOUNT BLVD & VISTA DEL ROSA SERVICE ISLAND 40FT E & 50FT S C/L INT	CY 1395
BASELINE (1975)	142.010	CS MON IN WELL 8IN DN ON C/L TELEGRAPH RD 20FT WLY C/L PARAMOUNT BLVD MKD (BELL K4 1941)	CY 1397
BASELINE (1975)	142.613	L&BN 4FT S BCR @ SW COR BIRCHBARK AVE & TELEGRAPH RD 80FT S & 18FT W/O C/L INT	CY 1593
BASELINE (1975)	144.974	L&BN 4FT S BCR @ SW COR STAMPS RD & TELEGRAPH RD 78FT S & 18FT W/O C/L INT	CY 1594
BASELINE (1975)	138.576	RAM SET CTR CB RET SE COR LAKEWOOD BLVD & TELEGRAPH RD 55FT S & 55FT E C/L INT	CY 1596
BASELINE (1975)	137.775	CS MON MKD (LACC SUR TRAVERSE STA BELL K-5A RE2177 1941) IN WELL W/COVER @ CL INT TELEGRAPH RD & LAKEWOOD BLVD	CY 1597
BASELINE (1975)	138.368	L&T S END W GAS ISLAND NE COR TELEGRAPH RD & SERAPIS AVE 67FT N & 61FT E/O C/L INT	CY 1599
BASELINE (1975)	137.134	L&T IN S CB TELEGRAPH RD 6FT W/O CB RET @ SE COR SERAPIS AVE 40FT S & 50FT E/O C/L INT	CY 1600
BASELINE (1975)	141.124	L&BN 1FT FROM BCR SERVICE RD N CB @ PASSONS BLVD & TELEGRAPH RD 50FT S C/L TELEGRAPH RD	CY 1601
NORWALK (1975)	108.370	CITY ENG TAG E CB 5FT S/O BCR @ SE COR WOODRUFF AVE & FIRESTONE BLVD 110FT S/O & 40FT E/O C/L INT	CY 1690

QUAD-YEAR	ELEV	DESCRIPTION (INCLUDE QUAD AND YEAR IN DESCRIPTION)	BM NUMBER
NORWALK (1975)	108.493	L&BN S CB FIRESTONE BLVD 50FT S/O C/L & 175FT E/O C/L PROD WOODRUFF AVE TO N	CY 1691
NORWALK (1975)	116.375	L&BN E CB 1FT N BCR @ NE COR WOODRUFF AVE & BUELL ST 20FT E & 50FT N C/L INT	CY 1693
NORWALK (1975)	119.525	RD MON IN WELL 8 INCHES DN @ DR NEAR C/L INT WOODRUFF AVE & GOTHAM ST MKD (LA CO RD DEPT 1954)	CY 1695
NORWALK (1975)	128.597	L&T C/L INT WOODRUFF AVE & FLORENCE AVE	CY 1697
BASELINE (1975)	138.138	L&B W ECR @ SW COR TRUE AVE & TELEGRAPH RD ( SERVICE RD ) 47FT W & 15FT S/O C/L INT TRUE AVE & TELEGRAPH RD ( SERVICE RD )	CY 1708
BASELINE (1975)	137.232	CS BR CAP CONC MON IN CASING & COVER PI 6.82FT E C/L INT TRUE AVE & TELEGRAPH RD	CY 1709
NORWALK (1975)	81.998	L&BN S CB 2FT E BCR @ SE COR ROSECRANS AVE & SHOEMAKER AVE 38FT S & 60FT E C/L INT CB MKD (AT 74)	CY 1821
BASELINE (1975)	157.383	L&T W CB 18FT N/O BCR @ NW COR TELEGRAPH RD & LAUREL AVE 68FT N & 20FT W C/L INT	CY 1830
BASELINE (1975)	151.281	CS MON IN WELL 8IN DN @ DR NR C/L INT TELEGRAPH RD & BLOOMFIELD AVE MKD (WHITTIER E7-A)	CY 1837
BASELINE (1975)	153.136	L&T 1FT N SE COR 1ST CONC STEP 70FT N C/L TELEGRAPH RD & 67FT W C/L BLOOMFIELD AVE	CY 1838
BASELINE (1975)	143.396	L & BN NE COR CONC BASE OIL DERRICK SW COR WILLIS ST & TELEGRAPH RD 40FT S & 43FT W C/L INT	CY 1840
BASELINE (1975)	89.914	RDBM TAG S CB ROSECRANS AVE 40FT S C/L @ ANG PT OF CB TO BRIDGE OVER SAN GABRIEL RIV 500FT W BRIDGE	CY 1989
BASELINE (1975)	83.353	L & T 6FT W BCR @ SW COR PARAMOUNT BLVD & GARDENDALE ST 35FT S & 59FT W C/L INT	CY 2041
NORWALK (1975)	136.898	RDBM TAG IN W CB 0.5FT N BCR @ NW COR LAKEWOOD BLVD & GALLATIN RD 63FT N & 40FT W C/L INT	CY 2053
NORWALK (1975)	136.585	RDBM TAG 3.5FT S BCR @ SW COR LAKEWOOD BLVD & GALLATIN RD 40FT W & 66FT S C/L INT	CY 2054
NORWALK (1975)	91.448	L & BN 1FT N BCR @ NW COR PRISCILLA ST & LAKEWOOD BLVD 38FT W & 40FT N C/L INT	CY 2078

QUAD-YEAR	ELEV	DESCRIPTION (INCLUDE QUAD AND YEAR IN DESCRIPTION)	BM NUMBER
NORWALK (1975)	89.101	SQ/HD SPK W CB 44FT N BCR @ NW COR LAKEWOOD BLVD & ROSECRANS BLVD 113FT N & 38FT W C/L INT MKD (MVTI)	CY 2084
NORWALK (1975)	88.490	STATE OF CALIF DIV HWY BRASS CAP CTR RET SW COR LAKEWOOD BLVD & ROSECRANS BLVD 55FT S & 44FT W C/L INT MKD (BM 42-A-53)	CY 2085
NORWALK (1975)	85.752	REINFORCING STEEL ROD IN SW COR CONC APRON TO BLDG NO 14610 ON NE COR LAKEWOOD BLVD & JEFF ST 52FT E & 15FT N/O C/L INT	CY 2086
NORWALK (1975)	85.257	RDBM TAG W CB LAKEWOOD BLVD 45FT W/O C/L & 15FT S/O APPROX C/L PROD JEFF ST	CY 2087
NORWALK (1975)	79.391	CO ENG TAG W CB 25FT S/O BCR @ SW COR LAKEWOOD BLVD & COMPTON BLVD 95FT S & 38FT W C/L INT	CY 2089
NORWALK (1975)	100.112	L & T 3FT W BCR N CB PKWY 35FT S C/L IMPERIAL HWY & 40FT W C/L DOWNEY RD	CY 2327
BASELINE (1975)	66.220	L&T CTR CB RET @ SE COR ALONDRA BLVD & DOWNEY AVE 48FT S & 47FT E C/L INT	CY 2343
BASELINE (1975)	98.713	L&BN N CB ROSECRANS AVE NE COR BRIDGE OVER SAN GABRIEL RIV 1FT W OF E END OF BRIDGE 23FT N C/L ROSECRANS AVE	CY 2495
BASELINE (1975)	101.072	L&BN N CB ROSECRANS AVE @ NW COR BRIDGE OVER SAN GABRIEL RIV 1FT E OF W END OF BRIDGE 23FT N C/L ROSECRANS AVE	CY 2496
BASELINE (1975)	67.421	L&T NR W ED OF CONC WK AROUND HSE NO 8700 ALONDRA BLVD 57FT S & 25FT E C/L INT ALONDRA BLVD & HAYTER ST	CY 2589
BASELINE (1975)	67.392	LACS MON 30FT N & 70FT E C/L INT ALONDRA BLVD & CLARK AVE MKD (BM 6-8 1951)	CY 2596
BASELINE (1975)	73.279	L&T N CB 4FT W CB RET @ NW COR ALONDRA BLVD & BLAINE AVE 38FT N & 35FT W C/L INT	CY 2597
BASELINE (1975)	73.411	L&T IN N CB 3FT E CB RET @ NE COR ALONDRA BLVD & BLAINE AVE 38FT N & 32FT E C/L INT	CY 2598
BASELINE (1975)	74.110	L&BN S CB 1FT W CB RET @ SW COR ALONDRA BLVD & BELLFLOWER BLVD 46FT W & 38FT S C/L INT	CY 2600
BASELINE (1975)	65.358	L&BN W CB 7FT N OF BCR @ SW COR ALONDRA BLVD & VALLEY VIEW AVE 68FT S & 40FT W C/L INT	CY 2771

QUAD-YEAR	ELEV	DESCRIPTION (INCLUDE QUAD AND YEAR IN DESCRIPTION)	BM NUMBER
BASELINE (1975)	94.678	L&SPK N CB 4FT E BCR @ NE COR VALLEY VIEW AVE & STAGE RD 30FT N & 60FT E C/L INT CB MKD (RBM 1)	CY 2776
BASELINE (1975)	94.712	USC&GS MON FLUSH ON NE COR VALLEY VIEW AVE & STAGE RD 31.5FT N & 87FT E C/L INT 1.5FT N CB MKD (K 778-1945)	CY 2777
BASELINE (1975)	94.210	L&BN NR CTR OF BRIDGE NO 1273 40FT E/O C/L VALLEY VIEW AVE 800FT S FOSTER RD 137FT N C/L MAZSA DR	CY 2782
BASELINE (1975)	94.655	CS MON IN WELL 10IN DN ON NE COR VALLEY VIEW AVE & FOSTER RD 62FT N & 41FT E C/L INT 1FT BACK CB MKD (BM 1#6A 1961)	CY 2785
BASELINE (1975)	105.922	L&BN E CB 1FT N BCR @ NE COR VALLEY VIEW AVE & ADOREE ST TO THE E 57FT N & 38FT E/O C/L INT	CY 2786
BASELINE (1975)	115.829	L&BN E CB 1FT S BCR @ SE COR VALLEY VIEW AVE & IMPERIAL HWY 76FT S & 38FT E C/L INT	CY 2788
NORWALK (1975)	129.391	L & T 13FT W BCR @ NW COR FLORENCE AVE & BROOKSHIRE AVE 40FT N & 67FT W C/L INT	CY 2853
BASELINE (1975)	104.350	L & T 18FT S C/L SPRINGER ST & 70FT W C/L PARAMOUNT BLVD 8FT W BCR @ SW COR IN CB	CY 3168
BASELINE (1975)	110.277	L & B 1FT W BCR @ SW COR DE PALMA ST & PARAMOUNT BLVD 18FT S & 74FT W C/L INT	CY 3173
BASELINE (1975)	111.336	L & BRAD 1FT W BCR @ NW COR CLETA ST & PARAMOUNT BLVD 18FT N & 75FT W C/L INT	CY 3174
BASELINE (1975)	112.152	L&T 2FT W/O BCR @ SW COR BROOKMILL RD & PARAMOUNT BLVD 18FT S & 77FT W/O C/L INT	CY 3175
BASELINE (1975)	115.822	LACS MON IN WELL @ C/L INT 2ND ST & PARAMOUNT BLVD ( USE S EDGE )	CY 3182
BASELINE (1975)	123.950	L & T 2FT S BCR @ SW COR PARAMOUNT BLVD & FARM ST 55FT S & 38FT W C/L INT	CY 3183
NORWALK (1975)	121.056	L&T W CB NORWALK BLVD 1FT N CB RET @ NW COR ORACLE ST & NORWALK BLVD 45FT N & 38FT W C/L INT	CY 3280
NORWALK (1975)	119.717	L&SPK N CB SHY ST 3FT W CB RET @ NW COR SHY ST & NORWALK BLVD 16FT N & 69FT W C/L INT	CY 3281
NORWALK (1975)	95.045	L & BN 2FT W BCR @ SW COR IMPERIAL HWY & WOODRUFF AVE 38FT S & 76FT W C/L INT	CY 3306

QUAD-YEAR	ELEV	DESCRIPTION (INCLUDE QUAD AND YEAR IN DESCRIPTION)	BM NUMBER
NORWALK (1975)	94.371	L & T 38FT S C/L IMPERIAL HWY ON C/L PROD CORNUTA AVE FROM S	CY 3307
NORWALK (1975)	93.478	L & T CTR CB RET @ W END OF PKWY 30FT E C/L DUNROBIN AVE & 46FT S C/L IMPERIAL HWY	CY 3308
NORWALK (1975)	97.094	L & T N CB SERVICE RD 1FT E BCR @ SE COR IMPERIAL HWY & VERDURA AVE 52FT S & 38FT E C/L INT	CY 3313
NORWALK (1975)	97.151	L & T S CB IMPERIAL HWY 3FT E BCR @ SE COR BROOKSHIRE AVE 38FT S & 73FT E/O C/L INT	CY 3314
NORWALK (1975)	98.579	L&BN S CB SERVICE RD IMPERIAL HWY 2FT E DRWY HSE NO 8402 80FT S/O C/L IMPERIAL HWY ON OR NR C/L PRCD DOLAN AVE	CY 3315
BASELINE (1975)	83.725	L&T 1FT N BCR @ NW COR STUDEBAKER RD & ROSECRANS AVE 81FT N & 52FT W C/L INT	CY 3364
NORWALK (1975)	158.759	L&SPK NR SE COR CONC WK 66FT W CARMENITA RD & 81FT N C/L BEATY AVE NR SE COR OF BLDG	CY 4312
NORWALK (1975)	166.689	L&BR IN S CB LAKELAND RD 1FT W/O BCR 32FT S & 75FT W C/L INT LAKELAND AV & CARMENITA RD	CY 4314
NORWALK (1975)	168.684	L&T NR S EDGE OF CONC DRWY HSE NO 10762 CARMENITA RD 127FT N COL FLORENCE AVE & 57FT E C/L CARMENITA RD	CY 4317
NORWALK (1975)	97.065	L&BRAD N CB SERVICE RD 1FT W BCR @ SW COR IMPERIAL HWY & VERDURA AVE 52FT S/O & 40FT W/O C/L INT	CY 6101
NORWALK (1975)	94.942	L&T 1FT S/O BCR @ NW COR IMPERIAL HWY & LAKEWOOD BLVD 49FT N/O & 40FT W/O C/L INT	CY 6103
NORWALK (1975)	94.195	L&T IN RET 10FT E/O BCR @ NW COR IMPERIAL HWY & CLARK AVE 43FT N & 45FT W/O C/L INT	CY 6104
NORWALK (1975)	94.011	RDBM TAG S CB 5FT W/O BCR @ SE COR IMPERIAL HWY & CLARK AVE 40FT S/O & 55FT E/O C/L INT	CY 6105
NORWALK (1975)	92.111	L&T S CB 5FT E/O BCR @ SW COR IMPERIAL HWY & ARDIS AVE 40FT S/O & 40FT W/O C/L INT	CY 6106
NORWALK (1975)	93.591	L&BN S CB 3FT W/O BCR @ SW COR IMPERIAL HWY & BELLFLOWER BLVD 40FT S/O & 62FT W/O CL INT	CY 6108
NORWALK (1975)	96.789	RDBM TAG N CB 38FT E BCR @ NE COR CARMENITA RD & IMPERIAL HWY 42FT N & 113FT E C/L INT	CY 6124



QUAD-YEAR	ELEV	DESCRIPTION (INCLUDE QUAD AND YEAR IN DESCRIPTION)	BM NUMBER
NORWALK (1975)	163.352	RDBM TAG 40FT W C/L CARMENITA RD ON S P/L HSE NO 10615 400FT S BARRETT ST	CY 6132
NORWALK (1975)	85.822	L&T N CB ROSECRANS AVE 40FT N C/L @ CR NEAR C/L PROD CASTANA AVE TO THE S	CY 6133
NORWALK (1975)	85.357	L&T N CB ROSECRANS AVE 42FT N C/L & 34FT W C/L CASTANA AVE TO THE NORTH	CY 6134
NORWALK (1975)	78.136	RD HD SPK W CB 5FT S BCR @ SW COR ROSECRANS AVE & DOWNEY AVE 87FT S & 30FT W C/L INT MKD(XM98)	CY 6136
NORWALK (1975)	74.672	RD MON IN WELL 8IN DN @ CR NEAR C/L INT ROSECRANS AVE & ANDERSON ST MKD (LA CO RD DEPT 1953)	CY 6138
NORWALK (1975)	103.349	L & BN 1FT E BCR @ NE COR IMPERIAL HWY & VOLUNTEER AVE 40 N & 60FT E C/L INT	CY 6140
NORWALK (1975)	115.285	L&BN IN CONC BASE OF SWITCH SIGNAL STAND 65FT N/O C/L IMPERIAL HWY & 0.2MI E/O BLOOMFIELD AVE 15FT W/O W TRACK MKD (BM)	CY 6143
NORWALK (1975)	125.696	L&T W EDGE CONC WK TO BLDG NO 12935 IMPERIAL HWY 55FT N C/L & 320FT W C/L SHOEMAKER AVE	CY 6145
BASELINE (1975)	141.166	L&BN S CB 35FT W BCR @ SW COR TELEGRAPH RD & NORWALK BLVD 35FT S & 77FT W/O C/L INT MKD (BM)	CY 6675
BASELINE (1975)	167.341	L&T CTR CB RET @ ENT TO CANDLEWOOD CC 45FT S C/L TELEGRAPH RD @ BRAMBLEBUSH AVE	CY 6679
BASELINE (1975)	196.262	RDBM TAG 18FT E BCR @ NE COR 42FT N & 70FT E C/L INT VALLEY VIEW AVE & TELEGRAPH RD	CY 6680
BASELINE (1975)	187.285	L&T 5FT E BCR @ SW COR 54FT W & 43FT S C/L INT TELEGRAPH RD & COLIMA RD MKD (BM)	CY 6681
BASELINE (1975)	188.330	RDBM TAG 5FT W BCR @ SE COR 53FT E & 43FT S C/L INT TELEGRAPH RD & COLIMA RD	CY 6682
BASELINE (1975)	162.399	L&BRAD ELY CB 12FT S BCR @ NELY COR VALLEY VIEW AVE & LEFFINGWELL RD 88FT N & 42FT E C/L INT	CY 7008
BASELINE (1975)	65.222	RR SPK IN CONC IN NE ABUT TO RR BR 9/40 300FT SLY SERVICE RD OF SANTA ANA FRWY & 1500FT WLY VALLEY VIEW AVE	CY 7015
BASELINE (1975)	65.973	COE BR CAP FL IN SE COR BR ON SERVICE RD OF SANTA ANA FRWY ABT 1500FT WLY VALLEY VIEW AVE MKD (CC37 BM 2-1B)	CY 7016

QUAD-YEAR	ELEV	DESCRIPTION (INCLUDE QUAD AND YEAR IN DESCRIPTION)	BM NUMBER
BASELINE (1975)	78.703	RDBM TAG ELY HDWL ON NELY COR CARMENITA RD & FIRESTONE BLVD 100FT NLY & 30FT ELY APPROX C/L INT	CY 7020
BASELINE (1975)	76.200	USC&GS MON IN S HDWL CULV 500 B ON SPRR ABT 355FT NW C/L SHOEMAKER AVE & 420FT S/O C/L FIRESTONE BLVD (S-97 1932)	CY 7022
BASELINE (1975)	94.142	CAL STATE BM MON IN CB FL WITH WK ON SW COR FIRESTONE BLVD & NORWALK BLVD 83FT S & 23FT W C/L INT	CY 7023
BASELINE (1975)	98.349	USC&GS DISK VERT IN WALL OF FORMER BANK OF NORWALK BLDG ON NWLY COR FRONT ST & CLARKDALE AVE ( V98 1932 )	CY 7024
BASELINE (1975)	82.286	CS MON 10IN DN NW COR ROSECRANS AVE & STUDEBAKER RD 49FT N & 90 FT W C/L INT MKD ( BM6-2 1951)	CY 7026
BASELINE (1975)	80.445	L&T W CB 6FT S BCR @ SW COR WOODRUFF AVE & WASHINGTON ST 50FT S & 40FT W C/L INT	CY 7027
BASELINE (1975)	72.729	CS MON 10IN DN @ NW COR ALONDRA BLVD & BELLFLOWER BLVD 33FT N & 73FT W C/L INT MKD (BM 6-7 1951)	CY 7028
BASELINE (1975)	69.057	CS MON FL @ SE COR ALONDRA BLVD & LAKEWOOD BLVD 42FT S & 187FT E C/L INT MKD (BM 6-9A 1958)	CY 7029
BASELINE (1975)	77.869	CS MON FL IN C B @ NW COR PARAMOUNT BLVD & CENTURY BLVD 90FT N & 39FT W C/L INT MKD (BM 7-2A 1961)	CY 7030
BASELINE (1975)	80.548	CS MON FL IN C B ON NW COR PARAMOUNT BLVD & HARDING AVE 40FT N & 41FT W C/L INT MKD (BM 7-3A 1961)	CY 7031
BASELINE (1975)	79.846	CS MON 10IN DN ON NW COR HARDING AVE & PARAMOUNT BLVD 95FT N & 44FT W C/L INT MKD (BELL E 11A 1960)	CY 7032
BASELINE (1975)	105.609	CS REF MON IN WELL 40FT W/O C/L PARAMOUNT BLVD & 42FT S C/L PROD ALAMEDA ST MKD ( BELL G 9 RM-1)	CY 7033
BASELINE (1975)	105.640	CS REF MON IN WELL 40FT W/O C/L PARAMOUNT BLVD & 38FT N/O C/L PROD ALAMEDA ST MKD ( BELL G 9 RM2)	CY 7034
BASELINE (1975)	133.388	CS MON 10IN DN SE COR GALLATIN RD & PARAMOUNT BLVD 59FT E & 25FT S C/L INT MKD (BM 7-12 1951)	CY 7036

QUAD-YEAR	ELEV	DESCRIPTION (INCLUDE QUAD AND YEAR IN DESCRIPTION)	BM NUMBER
NORWALK (1975)	133.006	L&BN W CB NORWALK BLVD 2FT S BCR @ SW COR NORWALK BLVD & FLORENCE AVE 82FT S & 40FT W C/L INT	CY 7262
NORWALK (1975)	127.259	L&BN W CB NORWALK BLVD 1FT N BCR @ NW COR NOR- WALK BLVD & LAKE LAND RD 50FT N & 34FT W C/L INT MKD (BM)	CY 7263
NORWALK (1975)	126.574	L&BN W CB NORWALK BLVD 2FT S BCR @ SW COR NOR- WALK BLVD & LAKE LAND RD 52FT S & 34FT W C/L INT MKD (BM)	CY 7264
NORWALK (1975)	113.599	CS BR CAP MON 12IN DN 45FT E C/L NORWALK BLVD & 148FT S/O C/L ENT TO HOSPITAL 40FT S/O C/L TINA ST MKD (BM 2-9A RE 5869 1961)	CY 7265
NORWALK (1975)	105.158	L&BN 6IN E BCR IN N CB IMPERIAL HWY @ NE COR IMPERIAL HWY & NORWALK BLVD 40FT N & 75FT E C/L INT	CY 7266
NORWALK (1975)	104.780	L&BN 2FT N BCR IN W CB NORWALK BLVD @ SW COR NORWALK BLVD & IMPERIAL HWY 40FT W & 67FT S C/L INT	CY 7267
NORWALK (1975)	110.622	CS TAG S CB 18IN E BCR @ SW COR IMPERIAL HWY & BLOOMFIELD AVE 42FT W & 75FT S C/L INT	CY 7268
NORWALK (1975)	109.465	L&T N CB LEFFINGWELL RD 12FT E BCR @ NE COR LEFFINGWELL RD & MEYER RD 40FT N & 50FT E C/L INT	CY 7270
NORWALK (1975)	112.116	L&BN W CB 2FT N CB @ NW COR LOMA DR & LEFFINGWELL RD 55FT N & 20FT W C/L INT	CY 7271
BASELINE (1975)	159.123	L&BN W CB 4FT N BCR @ NW COR TELEGRAPH RD & GREENLEAF AVE 80FT N & 32FT W C/L INT MKD (BM)	CY 7449
NORWALK (1975)	126.252	L&BN W CB 7FT N BCR @ NW COR ALBURTIS AVE & DUNNING ST 48FT N & 18FT W C/L INT MKD (BM)	CY 7451
NORWALK (1975)	125.794	L&BN N CB 2FT E BCR @ NE COR ALBURTIS AVE & DUNNING ST 15FT N & 46FT E C/L INT MKD (BM)	CY 7452
NORWALK (1975)	122.432	L&BRAD W CB 16FT S BCR @ SW COR PIONEER BLVD SERVICE RD & PARKMEAD ST 58FT S & 80FT W C/L INT	CY 7453
NORWALK (1975)	139.172	CS MON IN WELL 12IN DN @ C/L INT LAKE LAND RD & BLOOMFIELD AVE	CY 7456
NORWALK (1975)	142.031	L&BN CONC FOOTING OF GATE ON NE COR LAKE LAND RD & BLOOMFIELD AVE 30FT N & 106FT E/O C/L INT MKD (BM)	CY 7457

QUAD-YEAR	ELEV	DESCRIPTION (INCLUDE QUAD AND YEAR IN DESCRIPTION)	BM NUMBER
NORWALK (1975)	145.663	L&BN S CB 1FT W BCR @ SW COR LAKELAND RD & GREENSTONE AVE 32FT S & 69FT W C/L INT MKD (BM)	CY 7458
NORWALK (1975)	148.508	L&BN E CB 1FT S BCR @ SE COR LAKELAND RD & GREENSTONE AVE 70FT S & 32FT E C/L INT MKD (BM)	CY 7459
NORWALK (1975)	151.795	L&BN W CB 4FT N BCR @ NW COR LAKELAND RD & SHOEMAKER AVE 70FT N & 40FT W C/L INT MKD (BM)	CY 7460
NORWALK (1975)	154.625	L&BN S CB LAKELAND RD 32FT S C/L & 9FT W C/L PROD PAINTER AVE MKD (BM)	CY 7462
NORWALK (1975)	155.219	L&BN N CB 2FT E BCR @ NE COR LAKELAND RD & PAINTER AVE 32FT N & 64FT E C/L INT MKD (BM)	CY 7463
NORWALK (1975)	139.860	CS MON IN WELL 18IN DN @ C/L INT FLORENCE AVE & BLOOMFIELD AVE	CY 7464
NORWALK (1975)	147.736	L&BN CONC COLLAR OF SEWER VENT ON SW COR BLOOMFIELD AVE & CLARK AVE 22FT S & 56FT W C/L INT MKD (BM)	CY 7466
NORWALK (1975)	146.488	CS MON IN WELL 14IN DN @ C/L INT BLOOMFIELD AVE & CLARK AVE	CY 7467
NORWALK (1975)	155.325	CS MON IN WELL 8IN DN @ C/L INT SHOEMAKER AVE & FUT FLORENCE AVE	CY 7468
NORWALK (1975)	156.544	L&BN SE COR CONC SLAB ON NE COR SHOEMAKER AVE & FUT FLORENCE AVE 40FT N & 40FT E C/L INT MKD (BM)	CY 7469
NORWALK (1975)	158.841	PK IN CTR CONC PLUG OF 8IN IP 24IN UP ON SW COR SHOEMAKER AVE & AT&SF RR 8FT S & 30FT W C/L INT 0.3MI S/O C/L TELEGRAPH RD	CY 7471
NORWALK (1975)	92.739	L&BN CONC FTG OF OLD GATE POST 1FT N & 1FT W/O NEW GATE POST NO 33 33FT E/O C/L CARMENITA RD & 0.25MI N/O FOSTER RD MKD (BM)	CY 7473
NORWALK (1975)	93.115	L&BN CONC FTG OF OLD GATE POST 2FT S/O NEW GATE POST NO 20 47FT W/O C/L CARMENITA RD & 0.25MI N/O FOSTER RD MKD (BM)	CY 7474
NORWALK (1975)	91.426	L&BN CONC FTG OF SLY GATE POST ON NW COR CARMENITA RD & FOSTER RD 47FT W & 110FT N/O C/L INT MKD (BM)	CY 7475
NORWALK (1975)	90.116	L&BN CONC WALL OF DRAINAGE DITCH ON SE COR CARMENITA RD & FOSTER RD 25FT S & 142FT E C/L INT MKD (BM)	CY 7476

QUAD-YEAR	ELEV	DESCRIPTION (INCLUDE QUAD AND YEAR IN DESCRIPTION)	BM NUMBER
NORWALK (1975)	85.678	L&BN S CB OF DR BLDG 13722 CARMENITA RD 70FT E C/L & 206FT S C/L CAMBRIDGE RD MKD (BM)	CY 7478
NORWALK (1975)	81.942	L&BN N CB 3FT E BCR @ NE COR ROSECRANS AVE & CARMENITA RD 40FT N & 78FT E C/L INT MKD (BM)	CY 7479
NORWALK (1975)	81.842	L&BN W CB 40FT S BCR @ SW COR ROSECRANS AVE & CARMENITA RD 113FT S & 40FT W C/L INT MKD (BM)	CY 7480
NORWALK (1975)	80.432	L&BN N CB ROSECRANS AVE 40FT N/O C/L & 0.1MI E/O BEST AVE MKD (BM)	CY 7482
NORWALK (1975)	92.516	L&BN S CB ROSECRANS AVE IN FRONT OF BLDG 13914 40FT S/O C/L & 78FT E/O C/L ANSON AVE MKD (BM)	CY 7485
NORWALK (1975)	94.542	L&T S CB ROSECRANS AVE 40FT S C/L & 86FT E ENT RD DEPT MAINT YD NO 13934 328FT E/O C/L ANSON AVE	CY 7486
NORWALK (1975)	82.235	RD HD SPK S CB 3FT W BCR @ SW COR ROSECRANS AVE & DINARD AVE 38FT S & 52FT W C/L INT CB MKD (AT 72)	CY 7488
NORWALK (1975)	67.788	LS 2687 TAG W CB 0.5FT N BCR @ SW COR MARQUARDT AVE & EXCELSIOR DR 32FT W & 60FT S C/L INT	CY 7491
NORWALK (1975)	67.128	L&BN S CB 2FT E BCR @ SE COR MARQUARDT AVE & MICA ST 26FT S & 70FT E C/L INT MKD (BM)	CY 7492
NORWALK (1975)	66.893	L&BN W CB MARQUARDT AVE 34FT W C/L & 22FT S C/L PROD MICA ST MKD (BM)	CY 7493
NORWALK (1975)	65.385	L&BN E CB 30FT N BCR @ NE COR MARQUARDT AVE & FREEWAY DR 90FT N & 32FT E C/L INT MKD (BM)	CY 7495
BASELINE (1975)	67.906	L&BN S CB FIRESTONE BLVD (S FRONTAGE RD SANTA ANA FRWY) 20FT S C/L & 0.25MI W MARQUARDT AVE IN FRONT PP 1119957E MKD ( BM ) 21FT W/O WLY COR BLDG CALAVAR CORP	CY 7497
BASELINE (1975)	69.077	L&BN S CB FIRESTONE BLVD (S FRONTAGE RD SANTA ANA FRWY) 20FT S C/L IN FRONT BLDG 13700 0.25MI W MARQUARDT AVE MKD (BM)	CY 7498
BASELINE (1975)	80.012	L&BN S CB FIRESTONE BLVD (S FRONTAGE RD SANTA ANA FRWY) 20FT S C/L & 90FT W C/L CARMENITA RD OFFRAMP MKD (BM)	CY 7499
BASELINE (1975)	77.620	L&BN CONC HDWL 23FT S C/L FIRESTONE BLVD (S FRONTAGE RD SANTA ANA FRWY) IN FRONT BLDG 13146 0.3MI W CARMENITA RD MKD ( BM ) 40FT E LOADING DOCK	CY 7500

QUAD-YEAR	ELEV	DESCRIPTION (INCLUDE QUAD AND YEAR IN DESCRIPTION)	BM NUMBER
BASELINE (1975)	77.556	L&BN S CB FIRESTONE BLVD (S FRONTAGE RD SANTA ANA FRWY 20FT S C/L NR E P/L BLDG 13100 AUTOMATIC SPRINKLER CORP 0.3MI W CARMENITA RD MKD ( BM )	CY 7501
BASELINE (1975)	78.738	L&BN CONC RET WALL ON SW COR SHOEMAKER AVE & SPRR @ COR 8FT CHAIN LINK FEN 35FT S & 44FT W C/L INT MKD (BM)	CY 7502
BASELINE (1975)	81.543	L&BN S HDWL CULV 23FT S C/L FIRESTONE BLVD (S FRONTAGE RD SANTA ANA FRWY ) 0.4MI W SHOEMAKER AVE MKD ( BM ) OPP NE COR BLDG NO 12680	CY 7503
BASELINE (1975)	81.472	L&BN N HDWL CULV 22FT N C/L FIRESTONE BLVD (S FRONTAGE RD SANTA ANA FRWY) 0.3MI W SHOEMAKER AVE MKD (BM)	CY 7504
BASELINE (1975)	140.626	LACS MON IN SE COR C B 122FT N & 21FT W C/L INT TELEGRAPH RD & PASSONS BLVD MKD (BM 4-15A 1968)	CY 7747
BASELINE (1975)	108.841	CS REF MON IN WELL 8IN DN @ SW COR PARAMOUNT BLVD & STEWART & GRAY RD 50 S & 50 W C/L INT 1FT BK OF WK MKD ( RM 1-1960)	CY 7763
BASELINE (1975)	108.118	RDBM TAG 1FT S BCR @ SW COR PARAMOUNT BLVD & 1ST ALLEY S COLE ST 17FT S & 38FT W C/L INT	CY 7764
BASELINE (1975)	97.398	CS REF MON IN WELL 8IN DN @ SW COR PARAMOUNT BLVD & IMPERIAL HWY 46FT S & 55FT W C/L INT MKD(RM-4 BELL F 10A 1960)	CY 7766
BASELINE (1975)	72.948	RDBM TAG 8FT N BCR INTO CB RET @ SW COR PARAMOUNT BLVD & COMPTON BLVD 59FT S & 40FT W C/L INT	CY 7768
BASELINE (1975)	75.613	L & T 40FT S BCR @ SW COR PARAMOUNT BLVD & ROSECRANS AVE 120FT S & 35FT W C/L INT	CY 7815
BASELINE (1975)	155.848	CS MON IN WELL 18IN DN @ SW COR TELEGRAPH RD & GREENLEAF AVE 21FT N & 30FT W C/L INT	CY 8221
BASELINE (1975)	150.281	L & T 1FT S BCR @ NWLY COR TELEGRAPH RD & MILLS AVE 45FT NLY & 34FT WLY C/L INT	CY 8222
BASELINE (1975)	153.557	RDBM TAG 2FT ELY BCR @ NELY COR TELEGRAPH RD & MILLS AVE 85FT ELY & 40FT NLY C/L INT	CY 8223
BASELINE (1975)	137.705	L & T 1FT E BCR @ NE COR TELEGRAPH RD & VICTORIA AVE 40FT N & 46FT E C/L INT	CY 8224
BASELINE (1975)	195.038	CS BM MON FL ON SW COR TELEGRAPH RD & VALLEY VIEW AVE 42FT S & 38FT W C/L INT MKD (BM 4 - 6B)	CY 8225

QUAD-YEAR	ELEV	DESCRIPTION (INCLUDE QUAD AND YEAR IN DESCRIPTION)	BM NUMBER
BASELINE (1975)	157.498	L & BN IN E CB 1FT S/O BCR @ SE COR VALLEY VIEW AVE & LEFFINGWELL RD 60FT S & 42FT E/O C/L INT	CY 8629
BASELINE (1975)	119.197	L & T IN CH SQ NR CTR CB RET @ NE COR VALLEY VIEW AVE & IMPERIAL HWY 50FT N & 51FT E/O C/L INT	CY 8631
BASELINE (1975)	102.991	RDBM TAG IN W CB 26FT S/O & 38FT W/O C/L INT @ VALLEY VIEW AVE & ADOREE ST TO THE E	CY 8632
BASELINE (1975)	95.155	L & T IN W CB 2FT S/O BCR @ SW COR OF VALLEY VIEW AVE & FOSTER RD 40FT W & 57FT S/O C/L INT	CY 8633
BASELINE (1975)	113.331	L & BN IN E CB 1FT N/O BCR @ NE COR VALLEY VIEW AVE & ROSECRANS AVE 77FT N/O & 40FT E/O C/L INT	CY 8634
BASELINE (1975)	111.725	L & T NR CTR CB RET @ SW COR VALLEY VIEW AVE & ROSECRANS AVE 56FT S/O & 50FT W/O C/L INT	CY 8635
BASELINE (1975)	79.894	RDBM TAG IN E CB 6FT N/O BCR @ NE COR VALLEY VIEW AVE & GANNET ST 70FT N & 38FT E/O C/L INT	CY 8636
BASELINE (1975)	79.394	RDBM TAG IN N CB 2FT W/O BCR @ NW COR VALLEY VIEW AVE & GANNET ST 26FT N & 78FT W/O C/L INT	CY 8637
BASELINE (1975)	74.072	LACS MON FL IN CONC ABUT @ NE COR BR NO1262 OVER LA MIRADA CK 46FT E/O C/L VALLEY VIEW AVE MKD (BM 1-2A 1968)	CY 8638
BASELINE (1975)	73.847	L & BN IN CHIS SQ IN W CB 40FT W/O C/L VALLEY VIEW AVE 1.5FT N/O L & T @ C/L CHANNEL OF BR # 1262 OVER LA MIRADA CREEK	CY 8639
BASELINE (1975)	66.932	L & T IN N CB 2FT E/O BCR @ NE COR OF VALLEY VIEW AVE & ALONDRA BLVD 40FT N & 76FT E/O C/L INT	CY 8640
NORWALK (1975)	92.175	L & T 40FT N C/L IMPERIAL HWY & 100FT E C/L ARDIS AVE	CY 8692
NORWALK (1975)	93.756	RDBM TAG 15FT E BCR @ NE COR IMPERIAL HWY & BELLFLOWER BLVD 40FT N & 74FT E C/L INT	CY 8693
NORWALK (1975)	97.151	RDBM TAG 3FT W BCR @ SW COR IMPERIAL HWY & ENT IC SERVICE RD @ FLATBUSH AVE 46FT S & 125FT W C/L INT	CY 8694
NORWALK (1975)	96.284	RAM SET 7FT N BCR INTO RET @ SE COR IMPERIAL HWY & FLATBUSH AVE 100FT S & 18FT E C/L INT	CY 8695
NORWALK (1975)	98.955	RDBM TAG 1FT W BCR @ SW COR IMPERIAL HWY & FAIRFORD AVE 38FT S & 54FT W C/L INT	CY 8696

QUAD-YEAR	ELEV	DESCRIPTION (INCLUDE QUAD AND YEAR IN DESCRIPTION)	BM NUMBER
NORWALK (1975)	99.150	L & BN 2FT E BCR @ SE COR IMPERIAL HWY & FAIRFORD AVE 42FT S & 36FT E C/L INT	CY 8697
NORWALK (1975)	100.627	RDBM TAG 13FT W/O BCR @ NW COR FIRESTONE BLVD & IMPERIAL HWY 40FT N & 110FT W/O C/L INT	CY 8698
NORWALK (1975)	100.990	MET WATER DIST MGN FL IN CB 33FT E BCR @ NE COR IMPERIAL HWY & FIRESTONE BL 40FT N & 96FT E C/L INT MKD (OJA56 1956)	CY 8699
NORWALK (1975)	105.139	RDBM TAG 6FT E BCR INTO RET @ NW COR IMPERIAL HWY & PIONEER BLVD 40FT N & 66FT W C/L INT	CY 8700
NORWALK (1975)	105.732	L & BN 2FT N BCR @ IMPERIAL HWY & PIONEER BLVD 75FT N & 38FT E C/L INT	CY 8701
NORWALK (1975)	113.206	RDBM TAG 2FT E BCR @ SE COR LEFFINGWELL RD & CARMENITA AVE 42FT S & 52FT E C/L INT	CY 8703
NORWALK (1975)	115.245	RDBM TAG 3FT E BCR @ NE COR LEFFINGWELL RD & CARMENITA AVE 42FT N & 120FT E C/L INT	CY 8704
NORWALK (1975)	111.704	L & BRAD 1FT W BCR @ NW COR LEFFINGWELL RD & LELAND AVE 42FT N & 30FT W C/L INT	CY 8705
NORWALK (1975)	112.693	RDBM TAG 6FT E BCR @ NE COR LEFFINGWELL RD & LELAND AVE 42FT N & 70FT E C/L INT	CY 8706
NORWALK (1975)	116.509	L&PK ON NW COR ORR & DAY RD & LAKELAND RD 168FT N & 20FT W C/L INT	CY 8707
NORWALK (1975)	115.943	L & T 20FT E C/L ORR & DAY RD ON C/L PROD LAKELAND RD	CY 8708
NORWALK (1975)	109.218	L & PK 3FT S BCR @ SE COR ORR & DAY RD & BEATY ST 50FT S & 20FT E C/L INT	CY 8710
NORWALK (1975)	90.068	RDBM TAG 1FT E BCR @ SE COR FAIRFORD AVE & FOSTER RD 70FT S & 48FT E C/L INT	CY 8711
NORWALK (1975)	90.706	RAMSET & WASHER 0.2FT E/O BCR @ NE COR FAIRFORD AVE & FOSTER RD 28FT N & 57FT E/O C/L INT WASHER MKD (STATE OF CALIF DIV OF HWYS)	CY 8712
BASELINE (1975)	116.550	CS BM MGN FL IN C B @ NW COR FIRESTONE BLVD & PARAMOUNT BLVD 125FT N & 41FT W C/L INT MKD (BM 7-8B 1970)	CY 8713
BASELINE (1975)	115.813	RDBM TAG 1FT E BCR @ NE COR FIRESTONE BLVD & PARAMOUNT BLVD 38FT N & 78FT E C/L INT	CY 8714



QUAD-YEAR	ELEV	DESCRIPTION (INCLUDE QUAD AND YEAR IN DESCRIPTION)	BM NUMBER
NORWALK (1975)	114.674	RDBM TAG 20 E BCR @ NE COR FIRESTONE BL & BROOKSHIRE AVE 38FT N & 88FT E C/L INT	CY 8715
NORWALK (1975)	97.872	RDBM TAG 1FT N BCR @ NE COR WOODRUFF AVE & EVEREST ST 40FT E & 48FT N C/L INT	CY 8717
BASELINE (1975)	83.930	LACS MON IN WELL 10IN DN @ SE COR ROSECRANS AVE & WOODRUFF AVE 61FT S & 75FT E C/L INT MKD (BM 6-6 A 1970)	CY 8718
NORWALK (1975)	125.935	RDBM TAG 2FT E BCR @ SE COR FLORENCE AVE & DOWNEY AVE 38FT S & 58FT E C/L INT	CY 8719
NORWALK (1975)	118.266	RDBM TAG 1FT E BCR @ NE COR FLORENCE AVE & PIONEER BLVD 40FT N & 73FT E C/L INT	CY 8720
NORWALK (1975)	120.023	L & T @ SW COR WOODRUFF AVE & GOTHAM ST 45FT S & 18FT W C/L INT 0.3 S OF L & BRAD	CY 8721
NORWALK (1975)	121.800	RDBM TAG @ SW COR PIONEER BLVD & GLENWORTH ST 67FT S & 28FT W C/L INT	CY 8722
BASELINE (1975)	140.703	CS MON IN WELL 1FT BK OF CB 2FT S/O BCR @ SW COR NORWALK BLVD & TELEGRAPH RD 41FT W & 50FT S/O C/L INT MKD ( BM 2-11B )	CY 8723
NORWALK (1975)	126.582	LACS MON FL 1FT BACK CB FACE @ SW COR LAKELAND RD & NORWALK BLVD 55FT S & 35FT W C/L INT MKD ( BM 2-10A 1965 )	CY 8724
NORWALK (1975)	113.306	RDBM TAG 4FT N BCR @ NW COR NORWALK BLVD & BEATY ST 47FT N & 38FT W C/L INT NR ENT TO C B	CY 8725
NORWALK (1975)	99.452	LACS MON IN WELL 8IN DN @ NE COR UNION ST & SAN ANTONIO DR 44FT N & 42FT E C/L INT MKD (BM 2-8 B 1970)	CY 8726
BASELINE (1975)	96.584	RDBM TAG 9FT E BCR @ NE COR SAN ANTONIO DR & FIRESTONE BLVD 40FT N & 85FT E C/L INT	CY 8727
BASELINE (1975)	96.217	DIV HWY TAG 9FT E BCR INTO RET @ SW COR SAN ANTONIO DR & FIRESTONE BL 40FT S & 68FT W C/L INT	CY 8728
NORWALK (1975)	90.676	L & T 26FT S BCR @ SW COR LAKEWOOD BLVD & GARDENDALE ST 58FT S & 45FT W C/L INT	CY 8729
NORWALK (1975)	164.819	RDBM TAG 40FT W C/L CARMENITA RD FRONT OF PP NO 1334051E OPP HSE #11320 700FT N MEYER RD	CY 8730
NORWALK (1975)	88.215	RDBM TAG 1FT N BCR @ NW COR CARMENITA RD & CAMBRIDGE ST 61FT N & 40FT W C/L INT	CY 8731

QUAD-YEAR	ELEV	DESCRIPTION (INCLUDE QUAD AND YEAR IN DESCRIPTION)	BM NUMBER
NORWALK (1975)	75.023	L & T 40FT S C/L ROSECRANS AVE & 42FT E C/L PROD ANDERSON ST	CY 8732
NORWALK (1975)	78.665	RDBM TAG 30FT E BCR @ SE COR ROSECRANS AVE & DOWNEY RD 40FT S & 96FT E C/L INT	CY 8733
NORWALK (1975)	81.776	RDBM TAG 1FT W BCR INTO RET @ NE COR ROSECRANS AVE & SHOEMAKER AVE 38FT N & 65FT E C/L INT	CY 8734
NORWALK (1975)	82.240	L & T 1FT E BCR @ SE COR ROSECRANS AVE & DINARD AVE 48FT E & 38FT S C/L INT	CY 8735
NORWALK (1975)	91.521	L & T 1FT E BCR @ NE COR ROSECRANS AVE MARQUARDT AVE 44FT N & 70FT E C/L INT	CY 8736
BASELINE (1975)	110.547	CSBM MON FL 1FT S CB @ SW COR ROSECRANS AVE & VALLEY VIEW AVE 41FT S & 170FT W C/L INT MKD (BM7-60 1970) 105FT W/O BCR	CY 8737
NORWALK (1975)	135.842	L&BN CONC FTG 6FT CHAIN LINK FENCE @ ANGLE PT IN FENCE 45FT N/O C/L LAKELAND RD @ E SIDE GATE NO 4 0.25MI E/O NORWALK BLVD MKD (BM)	CY 8738
BASELINE (1975)	158.469	LACS MON IN WELL 8IN DN 1FT W CB FACE 2FT N BCR @ NW COR TELEGRAPH RD & GREENLEAF AVE 33FT W & 78FT N C/L INT MKD (4-10 C 1970)	CY 8740
BASELINE (1975)	98.745	CDE MON FL IN SE COR BRIDGE OVER SAN GABRIEL RIVER 29FT S C/L ROSECRANS AVE MKD (SG 22 1959)	CY 8743
BASELINE (1975)	83.018	CS BM IN WELL 8IN DN @ NW COR ROSECRANS AVE & STUDEBAKER RD 58FT N & 90FT W C/L INT MKD (BM 6-2 A 1970)	CY 8744
BASELINE (1975)	94.231	L & T 0.4FTE BCR @ NELY COR SAN ANTONIO DR & PINE ST 18FT N & 78FT E C/L INT	CY 8745
BASELINE (1975)	77.633	LACS MON IN WELL 8IN DN @ NE COR CARMENITA RD & FIRESTONE BL 32FT N & 126FT E C/L INT MKD (BM 2-2 C 1970)	CY 8747
BASELINE (1975)	117.255	RAM SET 40FT E C/L PARAMOUNT BLVD & 3FT S C/L PROD 4TH PL	CY 8748
BASELINE (1975)	117.328	CS MON IN WELL 8IN DN 1FT BK OF CB @ NW COR PARA MOUNT BLVD & 5TH ST 52FT N & 41FT W/O C/L INT MKD ( BM 7-98 1970 )	CY 8749
BASELINE (1975)	121.980	RDBM TAG 1FT S BCR @ SW COR PARAMOUNT BLVD & HARPER AVE 45FT S & 40FT W C/L INT	CY 8750

QUAD-YEAR	ELEV	DESCRIPTION (INCLUDE QUAD AND YEAR IN DESCRIPTION)	BM NUMBER
NORWALK (1975)	105.744	LACS MON IN WELL 8IN DN 13FT S/O BCR 1FT BK OF CB @ SW COR WOODRUFF AVE & HALL RD 45FT S & 41FT W/O C/L INT MKD (BM 68-16 1970)	CY 8752
BASELINE (1975)	83.405	S & L IN S CB 0.5FT W/O BCR @ SW COR BLOOMFIELD AVE & ROSECRANS AVE 42FT S & 66FT W/O C/L INT	CY 8851
BASELINE (1975)	82.801	RDBM TAG IN N CB 2.5FT W/O BCR @ NE COR BLOOMFIELD AVE & FIRESTONE BLVD ( ACCESS RD ) 57FT ELY C/L BLOOMFIELD & 19FT NLY C/L FIRESTONE	CY 8852
BASELINE (1975)	187.744	CSBM MON FL 2FT BK GF CB 2FT E/O BCR @ NE COR LEFFINGWELL RD & TELEGRAPH RD 42FT N & 48FT E/O C/L INT MKD ( BM 1-90 )	CY 9198
BASELINE (1975)	190.891	L&T IN MCR @ NW COR TELEGRAPH RD & LEFFINGWELL RD 58FT N & 58FT W/O C/L INT	CY 9199
BASELINE (1975)	133.849	LAFC MON 45FT N/O C/L TELEGRAPH RD @ W END OF BRIDGE OVER LAFC CHANNEL 0.1 MI W/O VICTORIA AVE MKD ( BM 109-33915 1966 )	CY 9200
BASELINE (1975)	158.240	C S BM MON IN WELL 1FT BK OF CB 41FT N/O C/L TELEGRAPH RD & 20FT E/O C/L PROD TELECRON AVE MKD ( 4-7C 1970 )	CY 9201
BASELINE (1975)	158.342	L&BD S CB TELEGRAPH RD 42FT S/O C/L & 24FT W/O C/L PROD LAUREL AVE	CY 9202
BASELINE (1975)	158.220	RD BM TAG 1FT E/O BCR @ NE COR TELEGRAPH RD & PAINTER AVE 40FT N & 62FT E/O C/L INT	CY 9203
BASELINE (1975)	158.193	L&BN 1FT W/O BCR @ NW COR TELEGRAPH RD & PAINTER AVE 40FT N & 67FT W/O C/L INT	CY 9204
BASELINE (1975)	145.582	RD BM TAG IN N CB TELEGRAPH RD 42FT N & 26FT E/O C/L PROD SPRING ST OPP PP NO 1993730E	CY 9205
BASELINE (1975)	124.691	RD BM TAG IN CONC CB 40FT N & 0.2 MI E/O INT TELEGRAPH RD & PIONEER AVE 56FT W/O CTR SP RR BRIDGE NO 1201 (7FT W/O END CB)	CY 9207
BASELINE (1975)	132.914	L&T IN CTR CB RET @ NW COR TELEGRAPH RD & ORR & DAY RD 54FT N & 49FT W/O C/L INT	CY 9208
BASELINE (1975)	139.997	CS MON NEAR C/L TELEGRAPH RD 41FT W/O W ON-OFF RAMP 605 FWY 160FT E/O E END BRIDGE NO 53-213 OVER SAN GABRIEL RIVER MKD ( A-6A 1941 )	CY 9209
BASELINE (1975)	144.408	LAFC MON IN SIDEWK @ NW COR BRIDGE NO B 841 OVER SAN GABRIEL RIVER 27FT N/O C/L TELEGRAPH RD MKD ( 177-73 1952 )	CY 9210

QUAD-YEAR	ELEV	DESCRIPTION (INCLUDE QUAD AND YEAR IN DESCRIPTION)	BM NUMBER
BASELINE (1975)	142.419	L & CITY ENGR TAG IN CTR OF CB RET @ SW COR TELEGRAPH RD & PARAMOUNT BLVD 50FT W & 51FT S/O C/L INT	CY 9211
BASELINE (1975)	145.069	RDBM TAG IN W CB VALLEY VIEW AVE 42FT W/O C/L & 9FT S/O C/L PROD CUL-DE-SAC OF CHERE DR 0.2 MI S/O LEFFINGWELL RD	CY 9274
BASELINE (1975)	65.084	L&T 17FT E/O BCR @ SE COR FIRESTONE AVE & MARQUARDT AVE 86FT E & 22FT S/O C/L INT	CY 9275
BASELINE (1975)	69.695	STATE DIVISION OF HWY'S TAG IN LEAD IN CTR OF CB RET @ NE COR ALONDRA BLVD & FIRESTONE BLVD 46FT E & 50FT N/O C/L INT	CY 9276
BASELINE (1975)	83.433	L&T 5FT N/O BCR @ SE COR BLOOMFIELD AVE & ROSECRANS AVE 43FT E & 67FT S/O C/L INT	CY 9277
BASELINE (1975)	92.605	RDBM TAG IN S CB FIRESTONE BLVD 42FT S/O C/L & 0.25MI E/O NORWALK BLVD FT OF BLDG NO 12440 OPPOSITE SADDLEBACK SQUARE SIGN	CY 9279
BASELINE (1975)	94.978	RAMSET & TAG 4FT W/O BCR @ NW COR FIRESTONE BLVD & NORWALK BLVD 38FT N & 39FT W/O C/L INT MKD ( STATE OF CALIF DIVISION OF HWYS )	CY 9280
BASELINE (1975)	87.162	L&N IN ELY WALL OF C B 5FT W/O BCR @ NW COR ROSECRANS AVE & PIONEER BLVD 60FT W & 42FT N C/L INT	CY 9281
BASELINE (1975)	85.017	RDBM TAG 3FT W/O BCR @ NW COR ROSECRANS AVE ( SERVICE RD)& FAIRFORD AVE 15FT N & 45FTW C/L INT	CY 9282
BASELINE (1975)	84.631	RAMSET CTR OF CB RET @ SW COR WOODRUFF AVE & ROSECRANS AVE 47FT S & 52FT W/O C/L INT	CY 9283
BASELINE (1975)	77.505	RDBM TAG IN W CB WOODRUFF AVE IN S WALL C B 21FT N/O BCR @ NW COR WOODRUFF AVE & WOODRUFF PL 40FT W & 57FT N/O C/L INT	CY 9284
BASELINE (1975)	68.276	CS MON IN WELL 1FT BK OF WK @ NE COR ALONDRA BLVD & CLARK AVE 55FT N & 52FT E/O C/L INT	CY 9285
BASELINE (1975)	69.639	LS TAG IN CB 11FT W/O BCR @ NW COR ALONDRA BLVD & VIRGINIA AVE 54FT W & 40FT N/O C/L INT ( MKD LS 2428 )	CY 9286
BASELINE (1975)	69.183	RAMSET CTR CB RET @ NE COR ALONDRA BLVD & LAKEWOOD BLVD 42FT N & 57FT E/O C/L INT	CY 9287
BASELINE (1975)	68.079	L&BD 2FT E/O BCR @ NW COR ALONDRA BLVD & PITTS AVE 42FT N & 39FT W/O C/L INT	CY 9288

QUAD-YEAR	ELEV	DESCRIPTION (INCLUDE QUAD AND YEAR IN DESCRIPTION)	BM NUMBER
BASELINE (1975)	66.223	CS MON IN WELL 1FT BK OF WK @ NE COR ALONDRA BLV & DOWNEY AVE 51FT N & 59FT E/O C/L INT MKD ( BM 6-10A )	CY 9289
BASELINE (1975)	68.953	L&BN 6FT N/O BCR @ NW COR ALONDRA BLVD & ORIZABA AVE 73FT N & 28FT W/O C/L INT	CY 9290
BASELINE (1975)	68.385	L&BD IN CTR OF CB RET @ NE COR ALONDRA BLVD & PARAMOUNT BLVD 54FT N & 51FT E/O C/L INT	CY 9291
BASELINE (1975)	68.134	CS MON FL IN S WALL C B @ NW COR PARAMOUNT BLVD & ALONDRA BLVD 42FT W & 120FT N/O C/L INT MKD ( BM 6-11B 1975 )	CY 9292
BASELINE (1975)	72.392	CS MON 1FT BK OF WK CTR OF CB RET @ SW COR PARA- MOUNT BLVD & COMPTON BLVD 56FT W & 50FT S/O C/L INT MKD ( BM 6-13A 1970 )	CY 9293
BASELINE (1975)	109.576	L&T 1FT S/O BCR @ SE COR PARAMOUNT BLVD STEWART & GRAY RD 38FT E & 76FT S/O C/L INT	CY 9295
BASELINE (1975)	103.852	L&FC TAG IN CTR OF CB RET @ NW COR PARAMOUNT BL & QUILL DR 29FT N & 47FT W/O C/L INT	CY 9296
BASELINE (1975)	90.152	L&BD 1FT S/O BCR @ SE COR PARAMOUNT BLVD & ADOREE AVE 38FT E & 44FT S/O C/L INT	CY 9298
BASELINE (1975)	77.386	L&T CTR CB RET @ SW COR PARAMOUNT BLVD & ROSE- CRANS AVE 55FT S & 43FT W/O C/L INT	CY 9299
BASELINE (1975)	98.457	RDBM TAG 2FT E/O BCR @ NE COR IMPERIAL HWY & PARAMOUNT BLVD 67FT E & 40FT N/O C/L INT	CY 9658
NORWALK (1975)	100.083	L&BN 51FT E/O BCR @ SE COR IMPERIAL HWY & DOWNEY AVE 113FT E & 38FT S/O C/L INT	CY 9659
NORWALK (1975)	94.801	L&BR 1FT W/O BCR @ SW COR IMPERIAL HWY & LAKEWOOD BLVD 78FT W & 40FT S/O C/L INT	CY 9660
NORWALK (1975)	112.987	PK NAIL IN CONC CB @ W ABUT OF BRIDGE NO B968 38FT S/O C/L IMPERIAL HWY & 160FT W/O C/L SAN GABRIEL RIVER	CY 9661
NORWALK (1975)	112.993	PK NAIL IN CONC CB @ W ABUT OF BRIDGE NO B968 38FT N/O C/L IMPERIAL HWY & 160FT W/O C/L SAN GABRIEL RIVER (USE N EDGE)	CY 9662
NORWALK (1975)	103.420	LACS TAG 15FT W/O BCR @ SW COR IMPERIAL HWY & VOLUNTEER AVE 63FT W & 42FT S/O C/L INT	CY 9663
NORWALK (1975)	100.923	RDBM TAG IN W CB LEFFINGWELL RD 107FT N/O C/L IMPERIAL HWY & 42FT W/O C/L LEFFINGWELL RD	CY 9664

QUAD-YEAR	ELEV	DESCRIPTION (INCLUDE QUAD AND YEAR IN DESCRIPTION)	BM NUMBER
NORWALK (1975)	99.844	RDBM TAG IN E CB LEFFINGWELL RD 88FT N/O C/L IMPERIAL HWY & 42FT E/O C/L LEFFINGWELL RD	CY 9665
NORWALK (1975)	98.854	STATE OF CALIF DIV OF HWY MON FL @ BCR @ SE COR SAN ANTONIO DR & UNION ST 39FT S & 42FT E/O C/L INT	CY 9666
NORWALK (1975)	133.411	RDBM TAG IN N WALL C B 20FT N/O BCR @ NW COR NORWALK BLVD & FLORENCE AVE 42FT W & 95FT N/O C/L INT	CY 9667
NORWALK (1975)	87.928	RDBM TAG 5FT S/O BCR @ SE COR WOODRUFF AVE & ARTHURDALE ST 41FT S & 38FT E/O C/L INT	CY 9668
NORWALK (1975)	90.100	RAMSET CTR CB RET @ SE COR WOODRUFF AVE & FOSTER RD TO THE E 40FT S & 48FT E/O C/L INT	CY 9669
NORWALK (1975)	111.226	RDBM TAG 5FT W/O BCR @ SW COR FIRESTONE BLVD & LAKEWOOD BLVD 38FT S & 68FT W/O C/L INT	CY 9670
NORWALK (1975)	114.835	RDBM TAG 1FT N/O BCR @ SE COR BROOKSHIRE AVE & FIRESTONE BLVD 70FT S & 30FT E/O C/L INT	CY 9671
NORWALK (1975)	167.196	L&T 2FT S/O BCR @ SE COR CARMENITA RD & LAKELAND RD 42FT E & 47FT S/O C/L INT	CY 9672
NORWALK (1975)	157.288	L&T 3FT N/O BCR @ NE COR CARMENITA RD & BEATY AVE 40FT E & 71FT N/O C/L INT	CY 9673
NORWALK (1975)	152.087	L&T 5FT E/O BCR @ NE COR LAKELAND RD & SHOEMAKER AVE 82FT E & 32FT N/O C/L INT @ W END C B	CY 9674
BASELINE (1975)	132.261	RDBM TAG 1FT E/O BCR @ SE COR TELEGRAPH RD & ORR & DAY RD 40FT S & 77FT E/O C/L INT	CY 9675
BASELINE (1975)	132.656	RDBM TAG 1FT W/O BCR @ SW COR TELEGRAPH RD & ORR & DAY RD 42FT S & 77FT W/O C/L INT	CY 9676
NORWALK (1975)	123.198	RDBM TAG @ NW COR W SERV RD OF ORR & DAY RD 14FT W/O C/L SERV RD & 50FT N/O C/L CLARKMAN ST ( 3FT N/O BCR)	CY 9677
NORWALK (1975)	109.215	L&SPK 7FT S/O BCR @ SW COR ORR & DAY RD & LONGWORTH AVE 20FT W & 52FT S/O C/L INT	CY 9678
NORWALK (1975)	91.115	L&T 3FT W/O BCR @ SW COR ROSECRANS AVE & MARQUARDT AVE 42FT S & 72FT W/O C/L INT	CY 9679
NORWALK (1975)	68.209	LS TAG NO 2905 IN CHISEL SQ 11FT S/O BCR @ NW COR MARQUARDT AVE & EXCELSIOR DR 34FT W & 51FT N/O C/L INT	CY 9680

06/07/79

LOS ANGELES COUNTY ROAD DEPARTMENT  
SURVEY SECTION

PAGE 2!

QUAD-YEAR	ELEV	DESCRIPTION (INCLUDE QUAD AND YEAR IN DESCRIPTION)	BM NUMBER
NORWALK (1975)	116.043	RDBM TAG 1FT S/O BCR @ SE COR WOODRUFF AVE & BUELL ST 45FT S & 18FT E/O C/L INT	CY 9681
BASELINE (1975)	61.988	L&BR 3FT E/O BCR IN CONC CB 27FT S/O C/L FIRESTONE BLVD & 74FT E/O C/L VALLEY VIEW AVE (SOUTH SIDE OF SANTA ANA FRWY)	CY 10027
BASELINE (1975)	61.858	L&BR 8FT E/O BCR IN CONC CB 27FT N/O C/L FIRESTONE BLVD & 75FT E/O C/L VALLEY VIEW AVE (SOUTH SIDE OF SANTA ANA FRWY)	CY 10028